



kaleidescape®

# WARNING!

IMPORTANT—Please read:

**1. DO NOT PUSH THE BUTTONS ON THE FRONT PANEL OF THE CHANGER (POWERFILE C200).**

Doing so may cause your Bulk Loader System to reset and require service. Please follow the warning labels.

**2. DO NOT MOVE OR PICK-UP THE CHANGER (POWERFILE C200) WHILE DVDS ARE LOADED INSIDE.**

Doing so may dislodge the DVDs and/or jam the Changer.

**3. DO NOT REMOVE THE COVER FROM THE CHANGER (POWERFILE C200) AT ANYTIME.**

If you have questions please contact Kaleidescape Technical Support at 650-625-6160.

# WARNING!



kaleidescape®

## DVD Bulk Loader Quick Reference

### Before You Begin

The DVD Bulk Loader significantly speeds up the process of importing large DVD collections into the Kaleidescape™ System. However, it's important to allow enough time to organize and import the collection. The DVD Bulk Loader Changer holds 200 DVDs, and it may take several hours to prepare them for importing.

The Changer imports two DVDs at the same time, and it takes about 25 minutes to import each pair of single-sided DVDs. Plan about 50 hours to import all 200 DVDs, and another hour and a half to return the DVDs to their cases.

### System Requirements

Your Kaleidescape System must be set up as described in the installation guide that came with your System. Be sure you have the following items:

- A Kaleidescape Server running Kaleidescape system software version 1.1.4-1167 or later (Verify the version number at <http://my-kaleidescape/user>. If you're not running this version, contact Kaleidescape Support.)
- A Kaleidescape DVD Reader
- CAT-5 or better network cable
- If you are using an existing PowerFile C200 and are adding only a Kaleidescape Controller, the PowerFile C200 must have firmware version 1.4.3.

**Note:** All components in the system must be in the same group. See the Groups page of the installer web utility for more information.

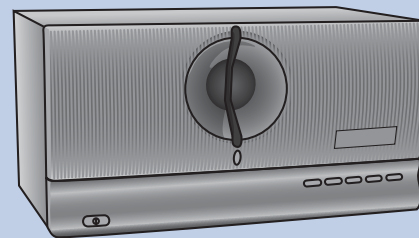

Changer

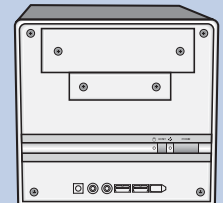

Controller

### Step 1: Connect

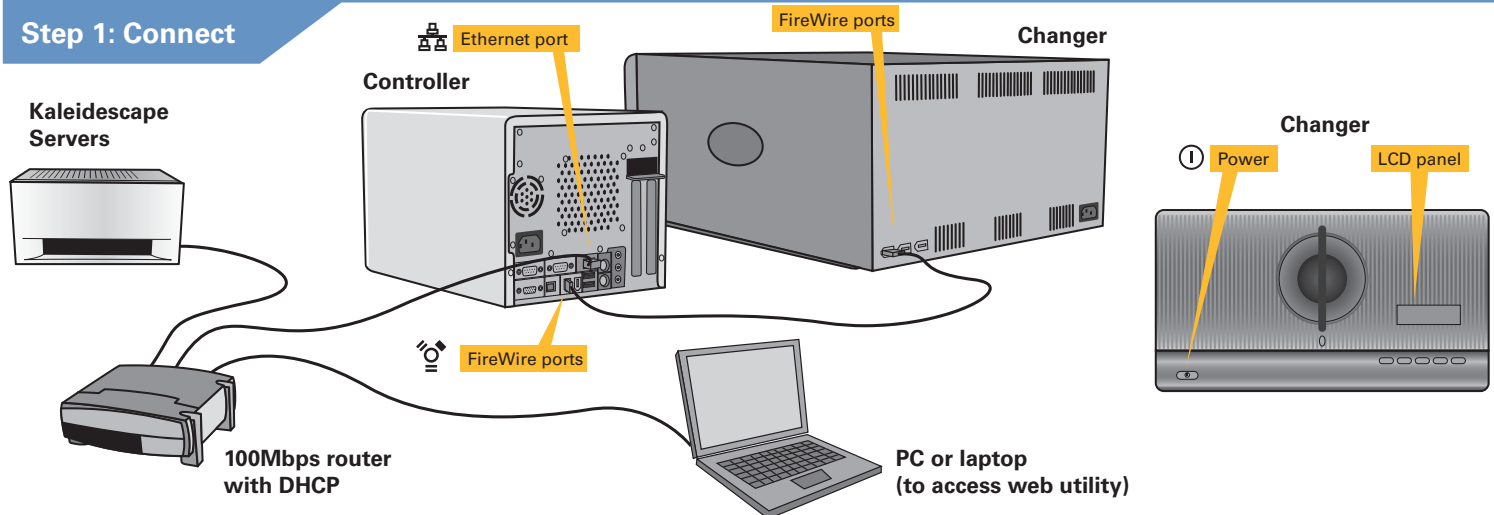

- 1 Connect the Ethernet port on the Controller to the network using CAT-5 or better cable. The recommended network configuration uses a single 100Mbps router with DHCP.
- 2 Use the FireWire® cable to connect a FireWire port on the Controller to a FireWire port on the Changer.
- 3 Connect the power cords of both units to a grounded power source.
- 4 Turn on the Kaleidescape Server, if it isn't already on, and wait for the indicator lights to turn blue.
- 5 From a web browser, open the installer web utility at <http://my-kaleidescape/installer> and be sure you see the Server.
- 6 Press the power button on the front of the Changer.

**Note:** You must wait for POWERFILE® C200, DVD CD JUKEBOX to appear in the LCD panel before turning on the Controller.

- 7 Press the power button on the front of the Controller and wait approximately one minute.
- 8 In the installer web utility, click the Components tab and verify that DVD Bulk Loader appears in the DVD Readers column. If not, group the Bulk Loader with the Kaleidescape Server, as described in the installation guide that came with your System.

**Note:** DO NOT use the front panel buttons on the Changer unless instructed to do so by Kaleidescape customer support.



## Step 2: Organize

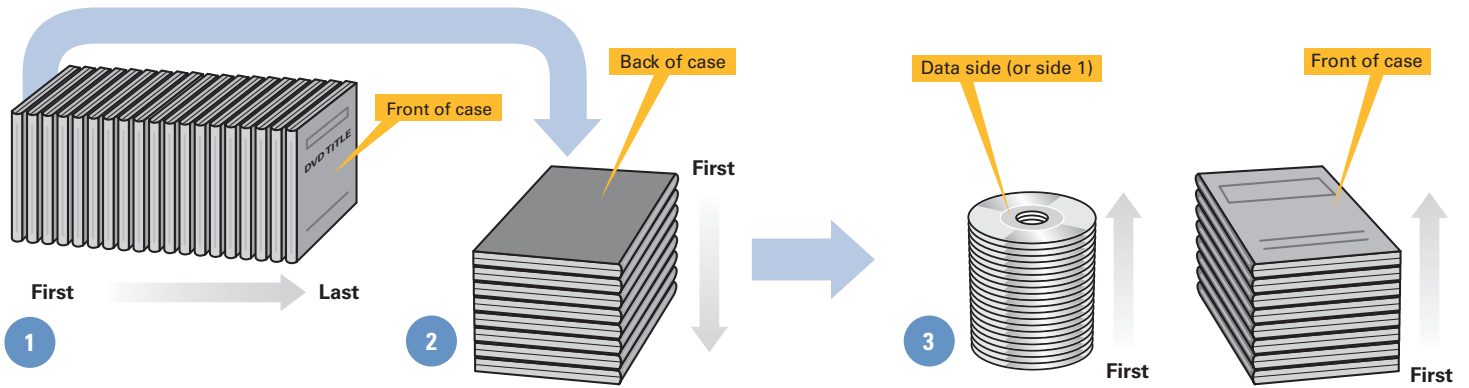

Organization is the key to successfully importing a large volume of DVDs. Although it may be time-consuming, organizing the collection makes it much easier for you to troubleshoot a problem or deal with failed imports.

**Tip:** Before continuing, keep the DVDs in their cases and separate the single-sided DVDs from the double-sided DVDs. Import the single-sided DVDs first, and then repeat the process for the double-sided DVDs.

- 1 With the DVDs still in their cases, organize the collection so that it's easy for you to manage. Be sure the back of each case is facing left.

**Important:** From this point on, be sure to keep the collection in this order.

- 2 From the organized collection, pull out a handful of DVDs and stack them on a table so that the first DVD in the collection is on top.
 

**Tip:** The back of the first DVD case should be facing up.
- 3 Remove the first DVD from its case and place it on a table with the label side (or side 2) facing down. Place the case on the table with the front facing up.
- 4 Repeat step 3 for the rest of the DVDs in the stack.
 

**Tip:** When you're finished, you should have 2 stacks: DVDs and empty cases.
- 5 Return the empty cases to the collection. You may want to place them on their sides to show that these DVDs are being imported.

## Step 3: Load and Import

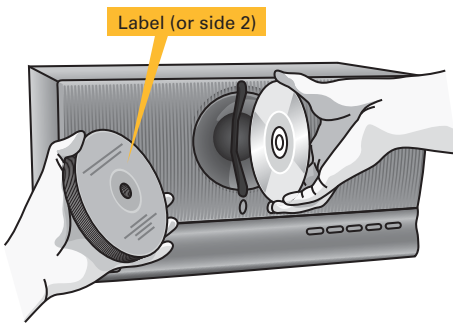

### Bulk Loader Web Utility



### Disc Details

Title	State
<input type="checkbox"/> Alex & Emma	Completed
<input type="checkbox"/> All That Jazz	Disc Identified
<input type="checkbox"/> An American in Paris	Disc Identified
<input type="checkbox"/> Amores Perros	Disc Identified
<input type="checkbox"/> The Good Fairy	Disc Identified
<input type="checkbox"/> Angel Heart	Disc Identified
<input type="checkbox"/> Anatomy of a Murder	Disc Identified
<input type="checkbox"/> The Andromeda Strain	Completed
<input type="checkbox"/> Anna and the King	Disc Identified
<input type="checkbox"/> Auto Focus	Disc Identified
<input type="checkbox"/> ...	Completed

- 1 Pick up a handful of DVDs so that the data sides face left.
- 2 From the installer web utility, click the link for the DVD Bulk Loader, and then click Load All.
- 3 Insert the DVDs carefully into the Changer with the data side facing left. Do not force.

**Note:** The door of the Changer automatically closes if a disc is not inserted within 5 seconds. To continue loading, click Load All on the web page.

- 4 Continue loading the rest of the DVDs that you want to import during this session.

**Important:** Once you begin loading the DVDs, do not lift, move or otherwise disturb the Changer. Doing so will cause the DVDs to jam.

- 5 After loading all of the DVDs, go to the Bulk Loader web utility and click Import All. Note the estimated import time. You may continue onto the next step while importing is in progress, or wait until it is completely finished.

**Tip:** Click the Disc Details tab to see the import progress. (This page does not refresh automatically.)



kaleidescape®

## Step 4: Review the Status

- 1 Open a second web browser window and go to <http://my-kaleidescape/user>
- 2 Click the Movie Import tab.
- 3 Use the chart below to review the import status of each DVD.

**Important:** Do not remove any DVDs from the Changer until you have completed the process in the chart below for all DVDs. If you are not able to obtain the required information for a particular DVD, check the box next to the DVD title in the Disc Details tab. After you have reviewed the status of all of the DVDs, click Eject and set these rejected DVDs aside.

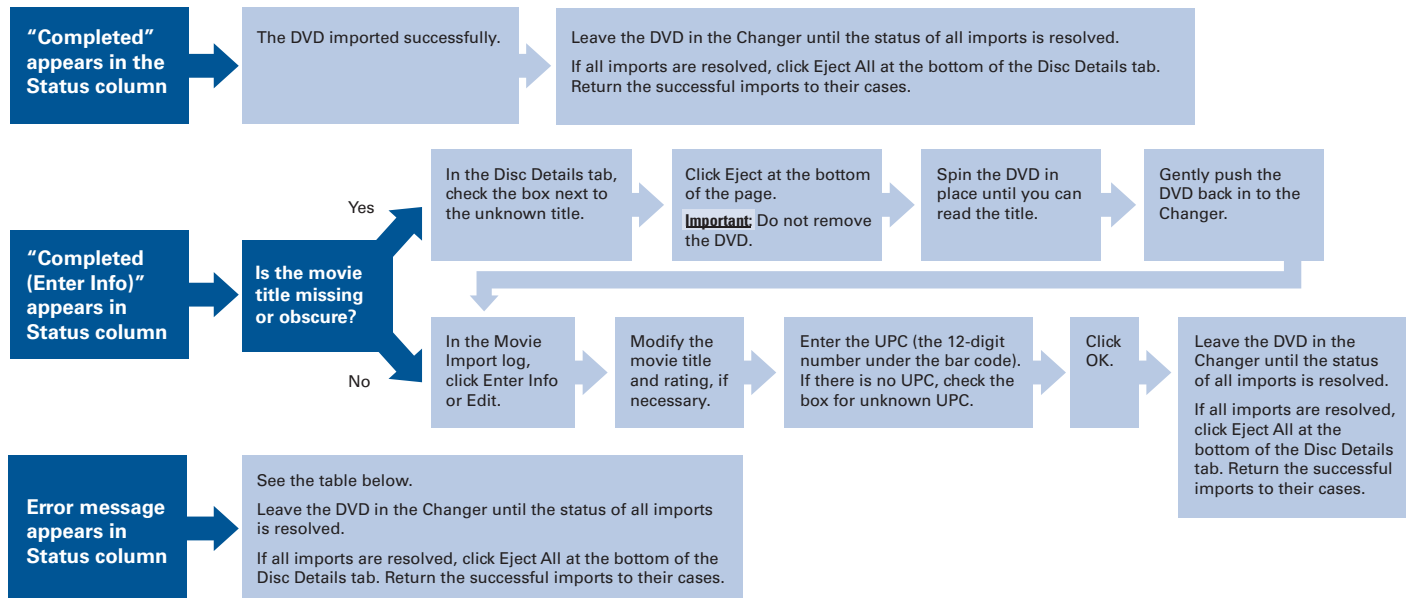

## Error Messages

If you receive an error message during importing, refer to this table to correct the problem.

For more help, visit <http://extranet.kaleidescape.com>. You'll also find information in the FAQ section of our website at <http://www.kaleidescape.com>.

If you still can't find the answer to your question, email us at [service@kaleidescape.com](mailto:service@kaleidescape.com), or call Kaleidescape Support at 1-650-625-6160. Our hours are Monday through Friday, 7:00 a.m. to 7:00 p.m. PST. Please be prepared to provide:

- Server serial number
- Date and time import failed
- Title of the DVD



kaleidescape®

© 2004 Kaleidescape, Inc. All rights reserved.

Kaleidescape and the Kaleidescape logo are trademarks of Kaleidescape, Inc. PowerFile is a registered trademark of PowerFile, Inc. FireWire is a registered trademark of Apple Computer, Inc.

Kaleidescape Part No. 101-0006 - Revision 4

Error Messages	Cause	Solution
Problem importing DVD	This is usually caused by imperfections in the DVD.	In the Disc Details tab, check the box next to the DVD title. Click Eject at the bottom of the page. Remove the DVD and clean it. Try importing it on the DVD Reader. If it still fails, contact Kaleidescape Support.
Import interrupted	The connection between the DVD Bulk Loader and the Server was lost.	Be sure all physical connections are secure. Be sure that all components of the System are turned on and appear in the installer web utility. Try importing again.
Disc is not a DVD	The disc is a CD. The disc is a DVD, but was inserted improperly. The disc is a DVD, but is so damaged that the DVD Bulk Loader doesn't recognize it.	Be sure the disc is not a CD. Be sure the DVD is inserted with the data side facing left. Try importing again. Check the DVD for cracks or scratches. The defect may not be visible.
Disc is not a region (1-8) DVD	The DVD's region number does not match the region number of the DVD Reader or DVD Bulk Loader that was used to import it.	Be sure the DVD's region number is compatible with the Kaleidescape™ System in use.
DVD bulk loader device disconnected	The DVD Bulk Loader may be physically disconnected, or not set to the correct group number.	Be sure physical connections are secure. Check group settings. Try importing again.
DVD Reader must be grouped with a Server	The DVD Reader is not grouped with a particular Server on the network, and there are at least 2 possible Servers.	Group the DVD Reader with one of the Servers, then try importing again.
DVD bulk loader aborted import	Importing was canceled by the DVD Bulk Loader.	Try to import again on the DVD Bulk Loader. If it fails again, try importing on the DVD Reader.
Server restarted during import	Importing was interrupted by a power outage, or by clicking the "Restart Server" link in the installer web utility.	On the Disc Details tab, click Select All, and then click Import.
Ran out of disk space	The DVDs exceed the capacity of the Server.	Contact Kaleidescape to purchase additional storage cartridges.
DVD CSS error	Requires access to server diagnostic log.	Contact Kaleidescape Support.
Unexpected problem with import	Requires access to server diagnostic log.	Contact Kaleidescape Support.